

IPHONES: (These are general directions for an Iphone. Settings, menus, etc. can change so this is a rough guide.)

Go to: Settings, Mail.

Add an account or choose your account to make changes to.

If you are using POP3 for your Incoming Mail Server, the settings should look like this (except for your email and password):

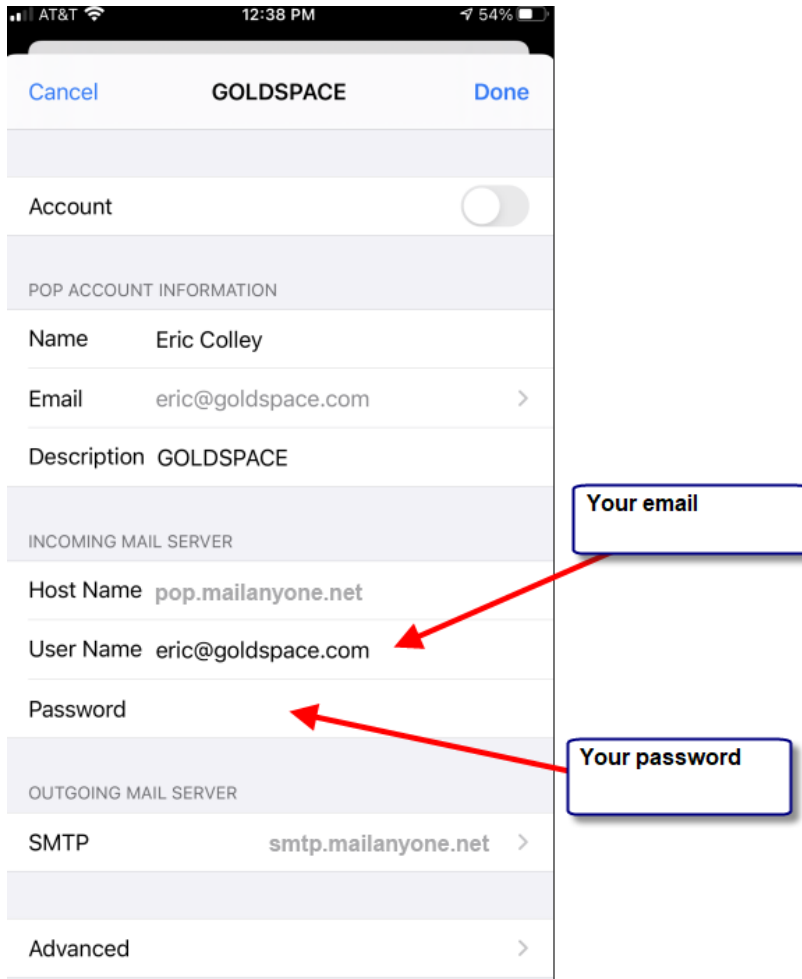

If you are using IMAP for Incoming Mail, then use these settings:

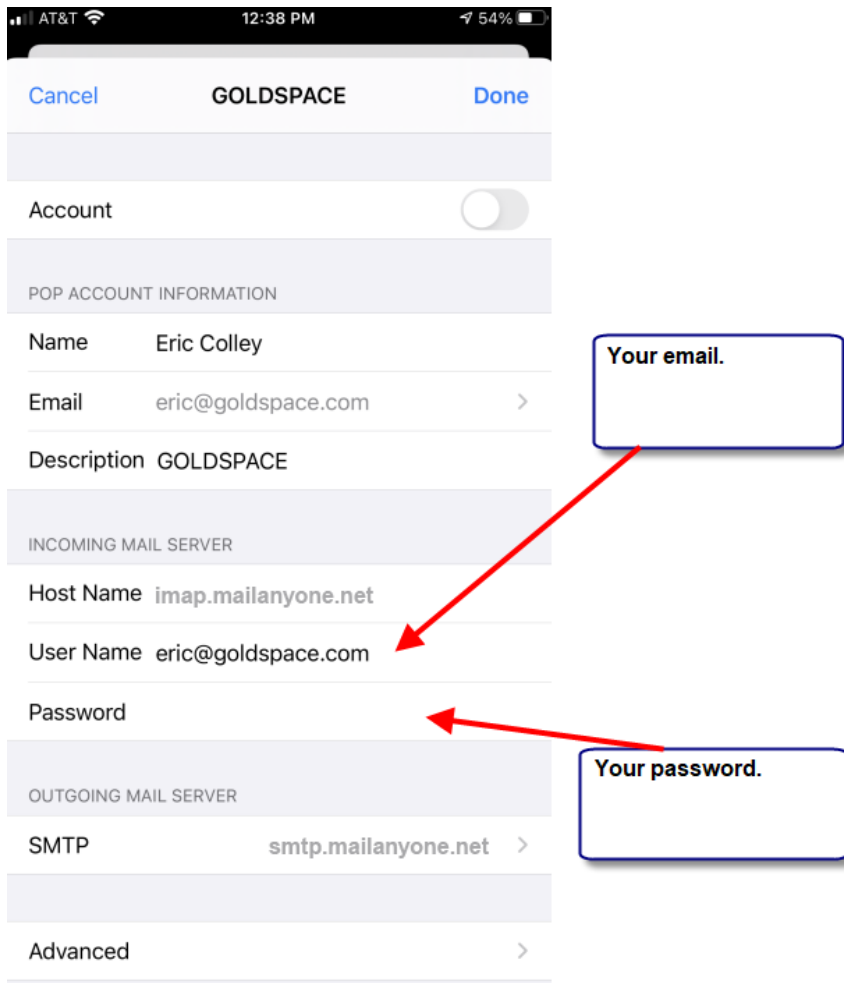

CLICK **ADVANCED** at the bottom of the page (POP3 and/or IMAP) to check these settings:

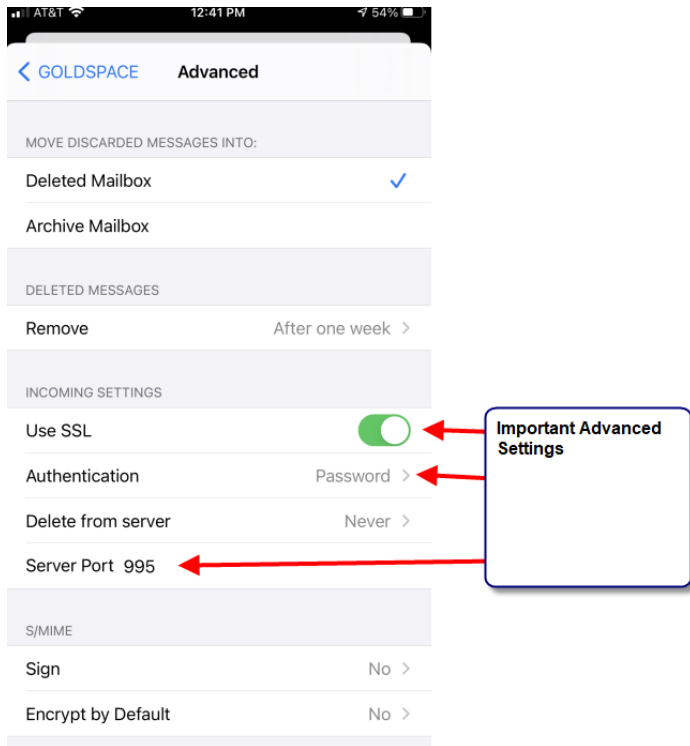

OUTGOING (SMTP) SERVER:

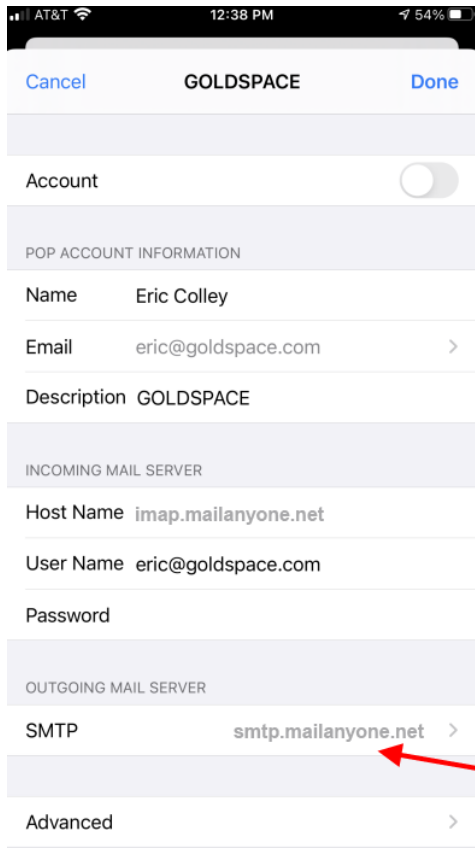

Click here to check SMTP settings

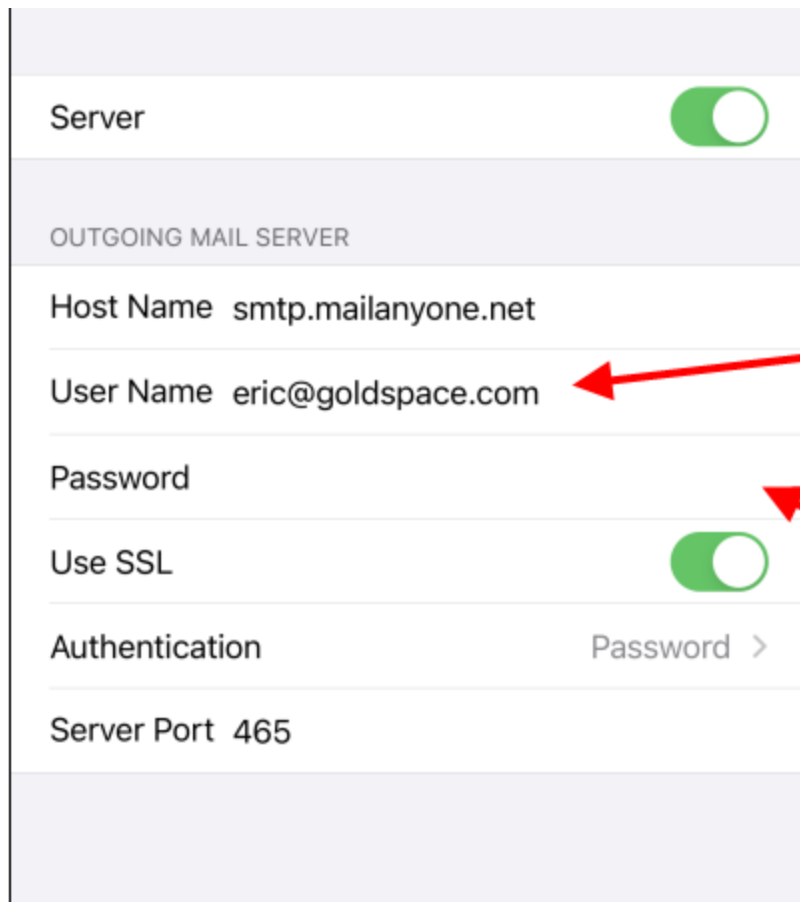

Your email.

Your password

If you are still having trouble, please check the PORT numbers, server names, email, and password. If any of these are incorrect, it will not work. You can try logging into the webmail interface with your email and password to verify that you have the password correct.